



### Technical Data

Wire sizes		Insulating Material	
Solid min	0.2 mm <sup>2</sup>	Material	PA 6.6
Solid max	2.5 mm <sup>2</sup>	Flammability Class	UL 94 V-0
Stranded (flexible) min	0.2mm <sup>2</sup>	<b>Temperatures</b>	
Stranded (flexible) max	2.5 mm <sup>2</sup>	Operating Temperature (without mech. load)	-40 °C - 105 °C
Stranded with Ferrule min	0.2 mm <sup>2</sup>	Store Temperature	-40 °C - 105 °C
Stranded with Ferrule max	2.5 mm <sup>2</sup>	<b>Wave Soldering Process</b>	
<b>Dimensions</b>		Soldering Temperature, recommended	260 °C
Stripped Length	6.0 mm	Peak Soldering Time, recommended	3-4 s
PCB Hole Diameter	1.3 mm	<b>Reflow Process</b>	
<b>Materials</b>		Soldering Temperature, recommended	-
Clamp	Brass	Peak Soldering Time, recommended	-
Wire Guard	Stainless Steel		
Screw	Steel		

### Colours

	GREY, RAL 7016
	BLUE, RAL 5015

Colours according to RAL, there may be variations on colour due to production conditions. Special colours on request.

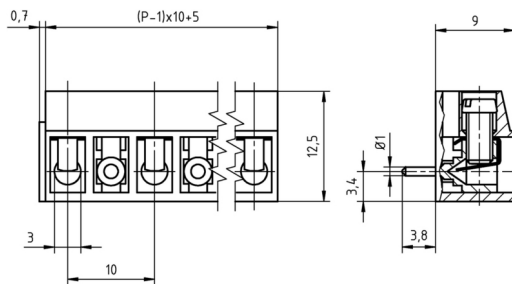

### Order Data (Spacing 10.0 mm)

Poles	Width (mm)	Article Designation	Article Number	PU
2	15.70	AK100/2DS-10.0-H-GREY	50100020240 G	250
3	25.70	AK100/3DS-10.0-H-GREY	50100030240 G	250
4	35.70	AK100/4DS-10.0-H-GREY	50100040240 F	200
5	45.70	AK100/5DS-10.0-H-GREY	50100050240 E	100
6	55.70	AK100/6DS-10.0-H-GREY	50100060240 E	100
7	65.70	AK100/7DS-10.0-H-GREY	50100070240 D	50
8	75.70	AK100/8DS-10.0-H-GREY	50100080240 D	50
9	85.70	AK100/9DS-10.0-H-GREY	50100090240 D	50
10	95.70	AK100/10DS-10.0-H-GREY	50100100240 D	50
11	105.70	AK100/11DS-10.0-H-GREY	50100110240 D	50
12	115.70	AK100/12DS-10.0-H-GREY	50100120240 D	50

### Ratings

UseGroup	C <sub>RU</sub> US			VDE	
	B	C	D		
Rated Voltage	300 V	150 V	300 V	1.000 V	
Rated Current	20 A	20 A	10 A	24 A	
Rated Wire Size				min	max
- solid	AWG 22-12	AWG 22-12	AWG 22-12	0.5 mm <sup>2</sup>	2.5 mm <sup>2</sup>
- stranded	AWG 22-12	AWG 22-12	AWG 22-12	0.5 mm <sup>2</sup>	2.5 mm <sup>2</sup>
Torque	0.45 Nm	0.45 Nm	0.45 Nm	0.50 Nm	
Screw Size	M3	M3	M3	M3	
Test Voltage	1.60 kV	1.30 kV	1.60 kV	3.5 kV	