

# AK3000/..-10.0-PEBBLE GREY



A Phoenix Mecano Brand

- 2 to n poles

## Technical Data

Wire sizes		Insulating Material	
Solid min	0.08 mm <sup>2</sup>	Material	PA 6.6
Solid max	2.5 mm <sup>2</sup>	Flammability Class	UL 94 V-0
Stranded (flexible) min	0.14mm <sup>2</sup>	<b>Temperatures</b>	
Stranded (flexible) max	2.5 mm <sup>2</sup>	Operating Temperature (without mech. load)	-40 °C - 105 °C
Stranded with Ferrule min	0.14 mm <sup>2</sup>	Store Temperature	-40 °C - 105 °C
Stranded with Ferrule max	1.5 mm <sup>2</sup>	<b>Wave Soldering Process</b>	
<b>Dimensions</b>		Soldering Temperature, recommended	260 °C
Stripped Length	6.0 mm	Peak Soldering Time, recommended	3-4 s
PCB Hole Diameter	1.1 mm	<b>Reflow Process</b>	
<b>Materials</b>		Soldering Temperature, recommended	-
Solder Tab	Copper Alloy	Peak Soldering Time, recommended	-
Tension Spring	Stainless Steel		

## Colours

	PEBBLE GREY, RAL 7032
	ORANGE, RAL 2011
	BLUE, RAL 5015
	LIGHT GREEN, similar RAL 6018

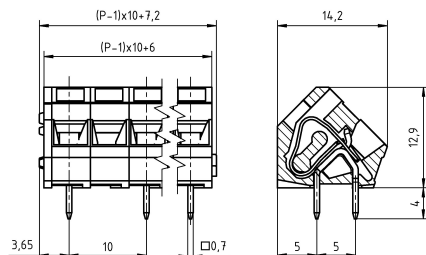

Colours according to RAL, there may be variations on colour due to production conditions. Special colours on request.



## Order Data (Spacing 10.0 mm)

Poles	Width (mm)	Article Designation	Article Number	PU
2	17.20	AK3000/2-10.0-PEBBLE GREY	53000020041 E	100
3	27.20	AK3000/3-10.0-PEBBLE GREY	53000030041 E	100
4	37.20	AK3000/4-10.0-PEBBLE GREY	53000040041 E	100
5	47.20	AK3000/5-10.0-PEBBLE GREY	53000050041 E	100
6	57.20	AK3000/6-10.0-PEBBLE GREY	53000060041 D	50
7	67.20	AK3000/7-10.0-PEBBLE GREY	53000070041 D	50
8	77.20	AK3000/8-10.0-PEBBLE GREY	53000080041 D	50
9	87.20	AK3000/9-10.0-PEBBLE GREY	53000090041 D	50
10	97.20	AK3000/10-10.0-PEBBLE GREY	53000100041 D	50
11	107.20	AK3000/11-10.0-PEBBLE GREY	53000110041 D	50
12	117.20	AK3000/12-10.0-PEBBLE GREY	53000120041 D	50
13	127.20	AK3000/13-10.0-PEBBLE GREY	53000130041 D	50
14	137.20	AK3000/14-10.0-PEBBLE GREY	53000140041 D	50
15	147.20	AK3000/15-10.0-PEBBLE GREY	53000150041 D	50
16	157.20	AK3000/16-10.0-PEBBLE GREY	53000160041 D	50
17	167.20	AK3000/17-10.0-PEBBLE GREY	53000170041 D	50
18	177.20	AK3000/18-10.0-PEBBLE GREY	53000180041 D	50
19	187.20	AK3000/19-10.0-PEBBLE GREY	53000190041 D	50
20	197.20	AK3000/20-10.0-PEBBLE GREY	53000200041 D	50
21	207.20	AK3000/21-10.0-PEBBLE GREY	53000210041 D	50
22	217.20	AK3000/22-10.0-PEBBLE GREY	53000220041 D	50
23	227.20	AK3000/23-10.0-PEBBLE GREY	53000230041 D	50
24	237.20	AK3000/24-10.0-PEBBLE GREY	53000240041 D	50

## Ratings

UseGroup					
	B	C	D		
Rated Voltage	300 V	300 V	-	1000 V	
Rated Current	15 A	15 A	-	24 A	
Rated Wire Size				min	max
- solid	AWG 28-14	AWG 28-14	-	0.5 mm <sup>2</sup>	2.5 mm <sup>2</sup>
- stranded	AWG 28-14	AWG 28-14	-	0.5 mm <sup>2</sup>	2.5 mm <sup>2</sup>
Test Voltage	1.60 kV	1.60 kV	-	3.5 kV	