

STLZ950/..-5.08-V-P2.6-BK-HC-HT



Technical Data

| Wire sizes | | Insulating Material | |
|---------------------------|--------------|--|-----------------|
| Solid min | - | Material | PPA |
| Solid max | - | Flammability Class | UL 94 V-0 |
| Stranded (flexible) min | - | Temperatures | |
| Stranded (flexible) max | - | Operating Temperature (without mech. load) | -40 °C - 105 °C |
| Stranded with Ferrule min | - | Store Temperature | -40 °C - 105 °C |
| Stranded with Ferrule max | - | Wave Soldering Process | |
| Dimensions | | Soldering Temperature, recommended | 260 °C |
| PCB Hole Diameter | 1.4 mm | Peak Soldering Time, recommended | 3-4 s |
| Materials | | Reflow Process | |
| Contact Pin | Copper Alloy | Soldering Temperature, recommended | 217 - 245 °C |
| | | Peak Soldering Time, recommended | 60 s |

Colours

 BLACK, RAL 9011

Colours according to RAL, there may be variations on colour due to production conditions.

Counterparts (Spacing 5.08 mm)

Terminal Block
AKZ950

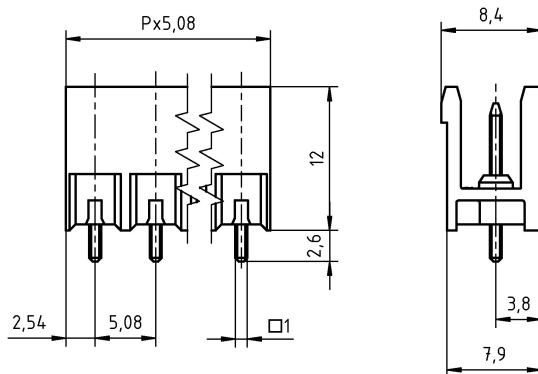



Order Data (Spacing 5.08 mm)

| Poles | Width (mm) | Article Designation | Article Number | PU |
|-------|------------|---------------------------------|----------------|-----|
| 2 | 10.16 | STLZ950/2-5.08-V-P2.6-BK-HC-HT | 50950025379 F | 200 |
| 3 | 15.24 | STLZ950/3-5.08-V-P2.6-BK-HC-HT | 50950035379 F | 200 |
| 4 | 20.32 | STLZ950/4-5.08-V-P2.6-BK-HC-HT | 50950045379 F | 200 |
| 5 | 25.40 | STLZ950/5-5.08-V-P2.6-BK-HC-HT | 50950055379 E | 100 |
| 6 | 30.48 | STLZ950/6-5.08-V-P2.6-BK-HC-HT | 50950065379 E | 100 |
| 7 | 35.56 | STLZ950/7-5.08-V-P2.6-BK-HC-HT | 50950075379 E | 100 |
| 8 | 40.64 | STLZ950/8-5.08-V-P2.6-BK-HC-HT | 50950085379 D | 50 |
| 9 | 45.72 | STLZ950/9-5.08-V-P2.6-BK-HC-HT | 50950095379 D | 50 |
| 10 | 50.80 | STLZ950/10-5.08-V-P2.6-BK-HC-HT | 50950105379 D | 50 |
| 11 | 55.88 | STLZ950/11-5.08-V-P2.6-BK-HC-HT | 50950115379 D | 50 |
| 12 | 60.96 | STLZ950/12-5.08-V-P2.6-BK-HC-HT | 50950125379 D | 50 |

Accessoires

| Figure | Designation | Article Number |
|--|--|-------------------------|
|  | Coding Star CS2-5.0/5.08-LIGHT GREY-HT | Order Data: 50000000028 |

Ratings

| UseGroup |  | | |  |
|----------------------|---|---------|---------|---|
| | B | C | D | |
| Rated Voltage | 300 V | 150 V | 300 V | 250 V |
| Rated Current | 16 A | 16 A | 10 A | 16 A |
| Overvoltage Category | | | | III |
| Test Voltage | 1.60 kV | 1.30 kV | 1.60 kV | 4.0 kV |
| Pollution Degree | | | | 3 |