

# STLZ1550/..G-3.81-H-P1.4-BK-HT



A Phoenix Mecano Brand

- Pin length 2.6 mm / 3.5 mm also available Kopie

## Technical Data

Wire sizes		Insulating Material	
Solid min	-	Material	LCP
Solid max	-	Flammability Class	UL 94 V-0
Stranded (flexible) min	-	<b>Temperatures</b>	
Stranded (flexible) max	-	Operating Temperature (without mech. load)	-40 °C - 105 °C
Stranded with Ferrule min	-	Store Temperature	-40 °C - 105 °C
Stranded with Ferrule max	-	<b>Wave Soldering Process</b>	
<b>Dimensions</b>		Soldering Temperature, recommended	260 °C
PCB Hole Diameter	1.2 mm	Peak Soldering Time, recommended	3-4 s
<b>Materials</b>		<b>Reflow Process</b>	
Contact Pin	Copper Alloy	Soldering Temperature, recommended	217 - 245 °C
		Peak Soldering Time, recommended	60 s

## Colours

BLACK, RAL 9011

Colours according to RAL, there may be variations on colour due to production conditions.

## Counterparts (Spacing 3.81 mm)

Terminal Block

AKZ1550      AKZ1700      AKZ1710      AKZ4551      AKZ4561

In combination of connectors with different admission data, the lower value is valid.

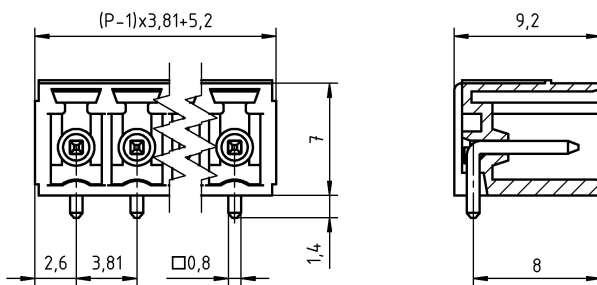

## Order Data (Spacing 3.81 mm)

Poles	Width (mm)	Article Designation	Article Number	PU
2	9.01	STLZ1550/2G-3.81-H-P1.4-BK-HT	51550025332 F	200
3	12.82	STLZ1550/3G-3.81-H-P1.4-BK-HT	51550035332 F	200
4	16.63	STLZ1550/4G-3.81-H-P1.4-BK-HT	51550045332 F	200
5	20.44	STLZ1550/5G-3.81-H-P1.4-BK-HT	51550055332 F	200
6	24.25	STLZ1550/6G-3.81-H-P1.4-BK-HT	51550065332 E	100
7	28.06	STLZ1550/7G-3.81-H-P1.4-BK-HT	51550075332 E	100
8	31.87	STLZ1550/8G-3.81-H-P1.4-BK-HT	51550085332 D	50
9	35.68	STLZ1550/9G-3.81-H-P1.4-BK-HT	51550095332 D	50
10	39.49	STLZ1550/10G-3.81-H-P1.4-BK-HT	51550105332 D	50
11	43.30	STLZ1550/11G-3.81-H-P1.4-BK-HT	51550115332 D	50
12	47.11	STLZ1550/12G-3.81-H-P1.4-BK-HT	51550125332 D	50

## Accessoires

Figure	Designation	Article Number
	Coding Star CS1-3.5/3.81-NATURAL-HT	Order Data: 5000000022

## Ratings



UseGroup	B	C	D	
Rated Voltage	300 V	-	300 V	160 V
Rated Current	10 A	-	10 A	10 A
Overvoltage Category				III
Test Voltage	1.60 kV	-	1.60 kV	2.5 kV
Pollution Degree				3